



YOUR MUSIC. **YOUR POWER.**

**OWNER'S MANUAL**  
**2400.4EVOX<sub>2</sub>**

**EVOX<sub>2</sub>**

Introduction .....	3
Package contents .....	3
Safety instructions .....	4
Technologies	
DTM® .....	5
I-Power Supply.....	5
Vibration Absorption Device .....	6
Reduced size .....	6
Assembling and Disassembling the plastic cover .....	7
Panels description	
Audio inputs and controls.....	8
Power inputs and audio outputs.....	9
Installation sequence .....	10
Electrical Dimensioning .....	11
Audio inputs	
RCA inputs.....	11
High Level input.....	11
Wiring diagram	
Four channels wiring diagram.....	12
Three channels wiring diagram .....	12
Two channels wiring diagram and Gain Setting.....	13
Crossovers set up .....	14
Technical specifications	
Parameters .....	15
Dimensional data .....	15

**DEAR CUSTOMER,****CONGRATULATIONS ON ACQUIRING A PRODUCT WITH THE HIGHEST QUALITY AND TECHNOLOGY!**

You have just purchased a SounDigital product of the highest technology and quality, so we thank you for your confidence.

**Class D Amplifiers:**

Class D amplifiers have as main characteristics the audio quality, efficiency, application versatility and compact design. Following are the advantages of these features:

**Audio Quality** – In the past, Class D products had limited response and for higher frequencies, Class AB products performed better, but their efficiency was very low. The new technologies introduced by SounDigital resulted in a Class D amplifier with high efficiency and superior Class AB performance.

**Efficiency** – SounDigital Class D amplifiers have total efficiency (output + power source) greater than 70%, which guarantees lower battery consumption and less heating.

**Application Versatility** – The flat full-frequency response of SounDigital amplifiers allows them to be used in all car sound systems. Meeting the demands with extreme quality.

**Compact Design** – The high efficiency and high technology applied, allows SounDigital amplifiers to be very compact, facilitating installation in vehicles where space is limited.

**IMPORTANT INFORMATIONS**

On this manual you will learn about the product, its features and characteristics, in order to obtain the best result and to be able to enjoy your music with SounDigital quality and power.

To better understand and take advantage of all the functions of the product and use it safely, read this manual carefully and if you have any questions, consult our support by email **[info@soundigitalusa.com](mailto:info@soundigitalusa.com)**.

**PACKAGE CONTENTS**

- 01 **2400.4 EVOX2** Amplifier
- 01 Installation quick guide with warranty card
- 01 Allen wrench 2.0mm
- 01 Allen wrench 2.5mm
- 01 Allen wrench 3.0mm
- 02 Cables for high level input
- 01 Promotional sticker

To prevent injuries to the user or damage to the amplifier, read all safety instructions written on this manual;

If you are insecure about the installation of this equipment, get in touch with our tech support or with a professional specialized in car audio installation;

Before proceeding with the installation of any electric equipment on your vehicle, unplug the negative (-) terminal of the battery to avoid fires, injuries or damages;

Use your sound system safely. The continuous exposure to sound pressures over 85dB may cause irreversible hearing damage;

This equipment is for use in automotive DC voltage batteries between 12.6 and 14.4 volts. Before installing the equipment, check voltage of the batteries;

Do not install the amplifier in places exposed to water, dirt or humidity;

Choose a ventilated place to install the amplifier and avoid blocking the side ventilation windows;

Mount the amplifier in a secure way. Avoid mounting it on metallic parts of the vehicle, because it may cause ground looping (noise);

When passing cables through metallic walls, use rubber O-rings to avoid cable cutting and short-circuits;

Make sure that the location chosen for the amplifier installation does not effect the operation of the vehicle;

This product may reach temperatures over 60°C (140°F). Make sure it is cold before touching it;

Clean the amplifier periodically with brush or dry cloth to assure the thermal efficiency of the heatsink;

Be careful when making holes in the vehicle. Make sure you are not making holes in the fuel tank, brake lines or electrical cables of the vehicle;

Make sure the cables are properly secured throughout the installation;

Wear gloves, safety glasses and all necessary PPE during the installation of SounDigital amplifiers.



### Warning!

THIS "WARNING" SIGN ALERTS THE USER OF IMPORTANT INFO. NOT FOLLOWING THESE INSTRUCTIONS MAY CAUSE INJURIES TO THE USER OR DAMAGE TO THE EQUIPMENT.

## DYNAMIC THERMAL MANAGEMENT - DTM®

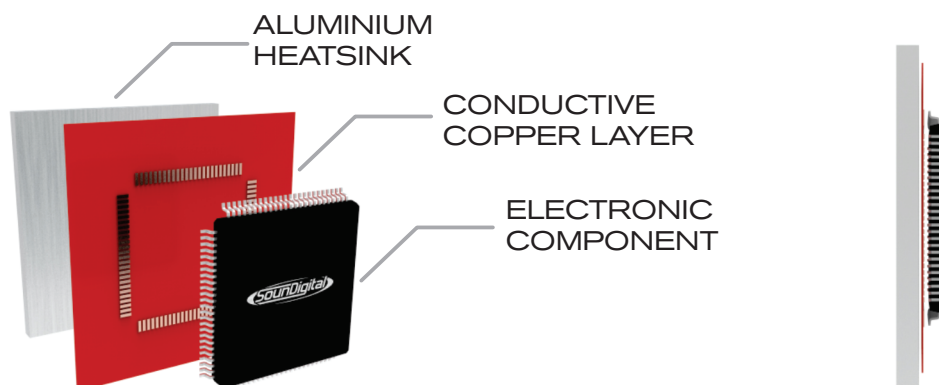

The **DTM**\* is a dynamic thermal recovery system which always maintains a high efficiency of the amplifier by accelerating the thermal exchange of electronic components with the heatsink.

*\*Patent required.*

## ULTRA COMPACT PCB

An intelligent layout, with great use of the PCB area and the use of modern components with reduced structure guarantee **Soundigital** products a compact design, at the same time robust and with excellent thermal efficiency.

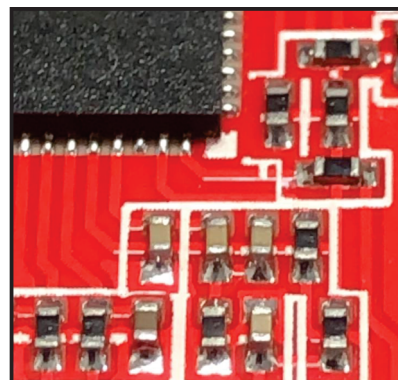

## I-POWER SUPPLY

Soundigital amplifiers are known for their low consumption of battery, and this feature was improved on the **EVOX2 Line**. The new **I-POWER SUPPLY** is even more modern, which replaces the old toroidal transformers by a new generation of "E-E" core transformers delivers efficiency above 90%\*, ensuring more hours of sound without battery recharge.

*\*Efficiency measured at power supply only.*



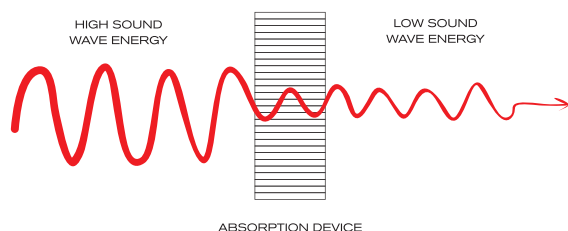

## VIBRATION ABSORPTION DEVICE - VAD®

Our VAD® Technology reduces all impact caused by vibration on the electronic circuit board. This can include road vibration and even vibration caused by sound waves, increasing the reliability of our amplifiers.

## REDUCED SIZE

The technology used in our amplifiers bring both high performance and power a compact chassis, providing flexible installation solutions for vehicles with limited space.

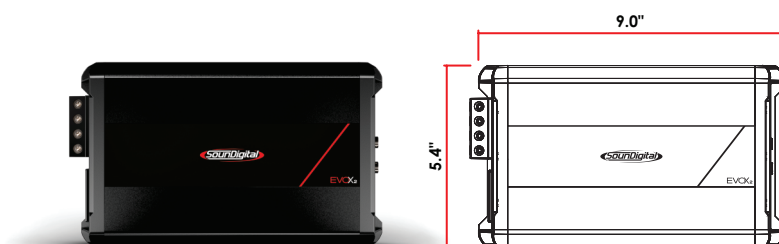

# FULL RANGE

## AMPLIFIER

## FULL RANGE

Versatile products that cover the entire audible frequency range, any type of loudspeaker or music program.

The plastic covers have the function of finishing and hiding the amplifier fixing screws. To disassembling and assembling them, follow the instructions below.

### DISASSEMBLING OF THE PLASTIC COVER

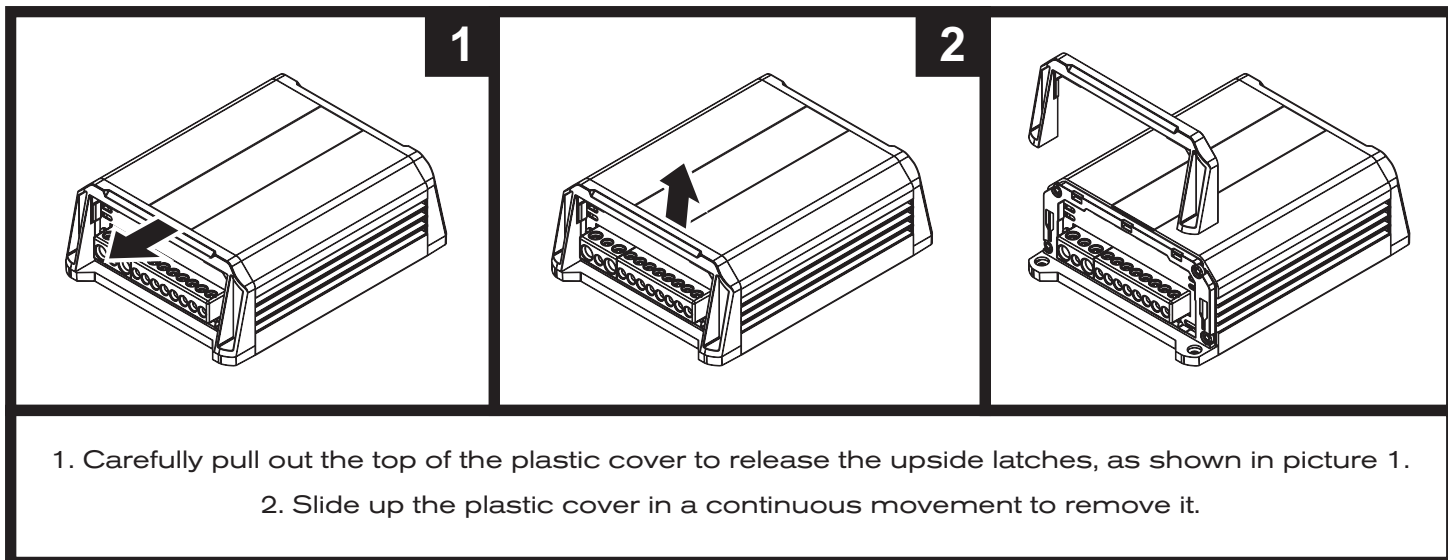

\*Merely illustrative images.

### ASSEMBLING THE PLASTIC COVER

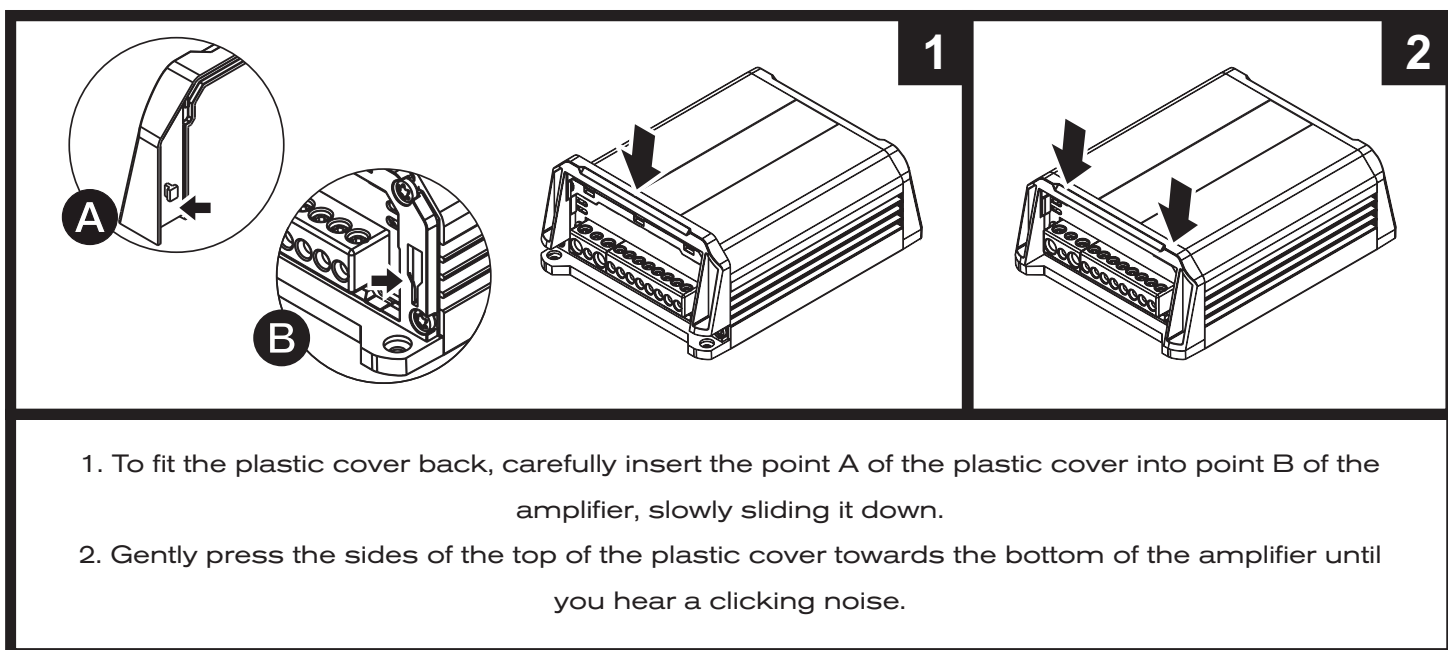

\*Merely illustrative images.

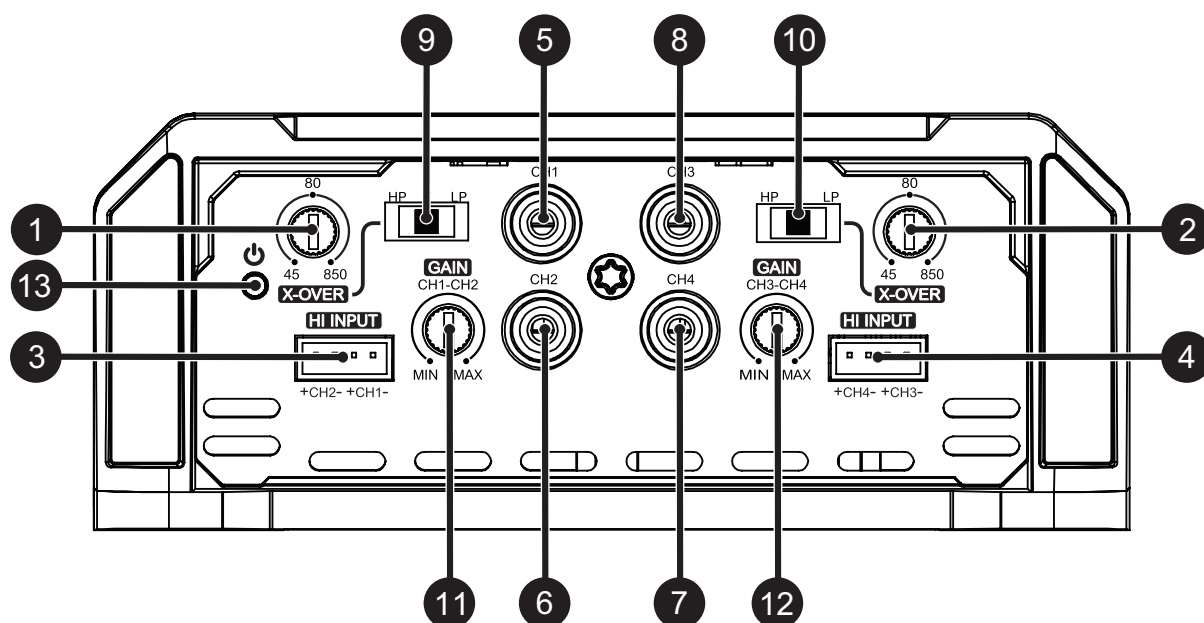

1	CH1/CH2	Variable crossover control (45Hz ~ 850Hz)
2	CH3/CH4	
3	CH1/CH2	Audio input – High Level (To connect to the speaker output of the head unit)
4	CH3/CH4	
5	CH1	Audio inputs – RCA connectors
6	CH2	
7	CH4	
8	CH3	
9	CH1/CH2	Crossover Switch Low Pass - Full - High Pass
10	CH3/CH4	
11	CH1/CH2	Variable Gain Control
12	CH3/CH4	
13	-	"POWER ON" LED indicator (Blue)



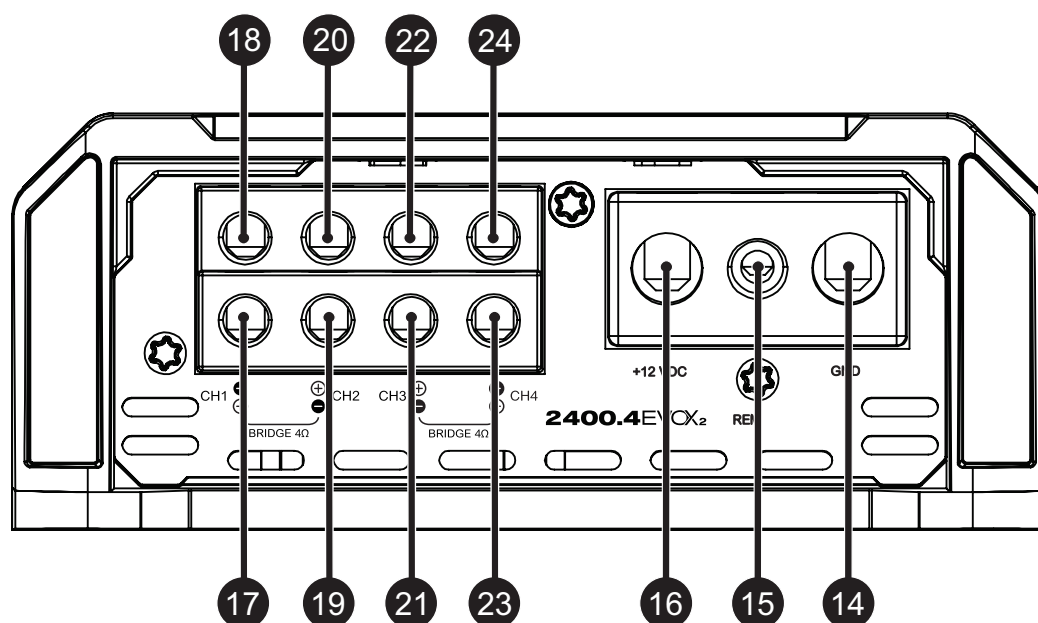

14	-	Negative power supply connector (GND)
15	-	Remote power supply connector (REM)
16	-	Positive power supply connector (+12VDC)
17	CH1	Positive speaker connector (+)
18		Negative speaker connector (-)
19	CH2	Negative speaker connector (-)
20		Positive speaker connector (+)
21	CH3	Negative speaker connector (-)
22		Positive speaker connector (+)
23	CH4	Positive speaker connector (+)
24		Negative speaker connector (-)

**Warning!**

BEFORE PROCEEDING WITH THE INSTALLATION, UNPLUG THE NEGATIVE TERMINAL FROM ALL OF THE BATTERIES, TO AVOID FIRE, DAMAGE TO THE AMPLIFIER AND THE USER HIMSELF.

- Mount the amplifier in such a way you have access to the connectors;
- Install the power cables in the vehicle properly, starting from the battery to the fuse holder or circuit breaker, use the cable with the appropriate size. Make all connections, install fuse holders or circuit breakers, but without placing the fuses or with the circuit breakers in the "OFF" position;

**Warning!**

THE MAXIMUM DISTANCE FOR THE INSTALLATION OF THE FUSE/CIRCUIT BREAKER IS 12 INCHES (30cm) AWAY FROM THE BATTERY.

- Connect the power cables in to the amplifier, observing the polarity. Connect all the positive cables (+) from the fuse holder or circuit breaker to the positive connector of the amplifier and all the negative power cables from the batteries to the negative connector of the amplifier;
- The ground cable must be as short as possible and must be connected to the vehicle chassis and the battery negative;

Remove the paint  
between the terminal  
and chassis

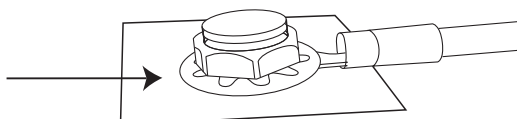

- Install the signal input cables in a proper way, distant from the power cables;
- Connect the RCA or the high level signal input cables to the head unit and amplifiers;
- Install the audio output cables with the appropriate section, distant from the power and audio input cables;
- Connect the audio output cables to the amplifier and speakers respecting the positive (+) and negative (-) polarities;
- Install the remote cable with the power cables, using 1.5mm<sup>2</sup> (15 AWG) cable or thicker;
- Connect the remote power cable to the amplifier's "REM" terminal at the main unit's remote power output (when not using the high level signal inputs);
- Before powering the system, verify all the connections and make sure there are no mistakes or short-circuits on the power and ground cables;
- Reconnect the ground of the batteries;
- Check if the head unit is turned off and then place the fuses in the fuse holders or switch the circuit breakers on;
- Turn on the main unit and the amplifier will turn on the "POWER ON" LED indicating that it is in operation.

**Warning!**

Minimum recommended  
installation distance  
between amplifiers\*.  
1.18in (30mm)

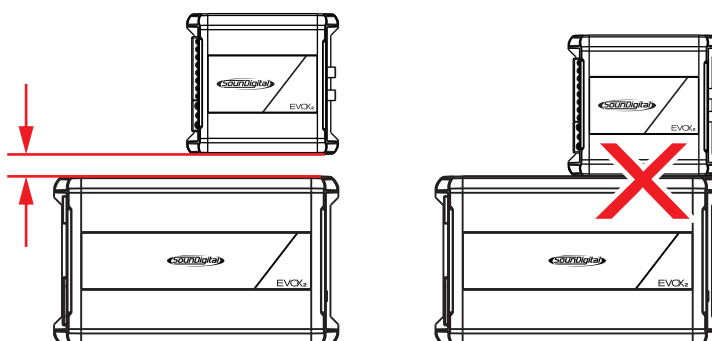

\*For installations with more than one amplifier, second unit not included. Merely illustrative images.

## ELECTRICAL DIMENSIONING

For proper operation of your SoundDigital amplifier, you need the proper dimensioning of the electrical system and the cables used.

The table below shows the minimum section of GND cables, +12VDC cables and speaker output cables according to the power generated by the amplifier.

2400 WRMS	POWER CABLE	21mm <sup>2</sup> (4 AWG)
	GROUND CABLE	
	SPEAKER CABLE	2 x 2mm <sup>2</sup> (14 AWG)

We recommend the use of only OFC (Oxygen Free Copper) cables on the installation of our products.

CCA cables must not be used.

## AUDIO INPUTS

### RCA inputs

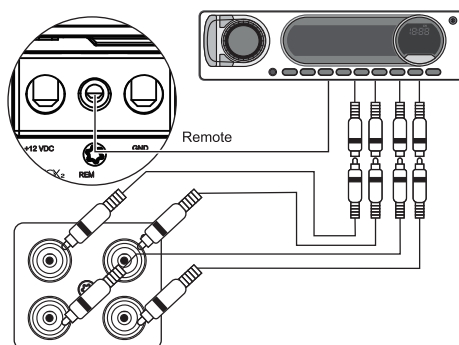

All RCA inputs must be connected for all the channels to work properly.

### High level signal inputs

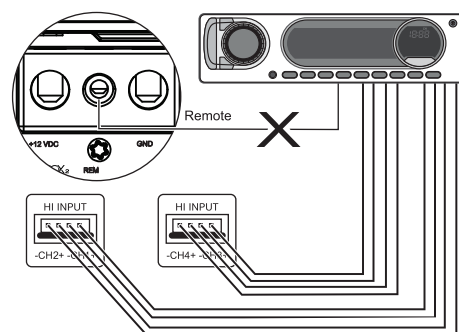

All High level signal Inputs must be connected for all the channels to work properly.

High level input must be used when the main unit does not have RCA outputs.

When High level input is used, no remote connection is required, the amplifier recognizes the audio signal and switches on.

If your source unit is not able to turn on the amplifier through the High level input, the remote input should be connected normally.



**Warning!**

RCA AND HIGH LEVEL INPUTS SHOULD NOT BE USED SIMULTANEOUSLY OR YOU MAY DAMAGE THE AMPLIFIER.

4 CHANNEL WIRING DIAGRAM

See "AUDIO INPUTS" on page 11

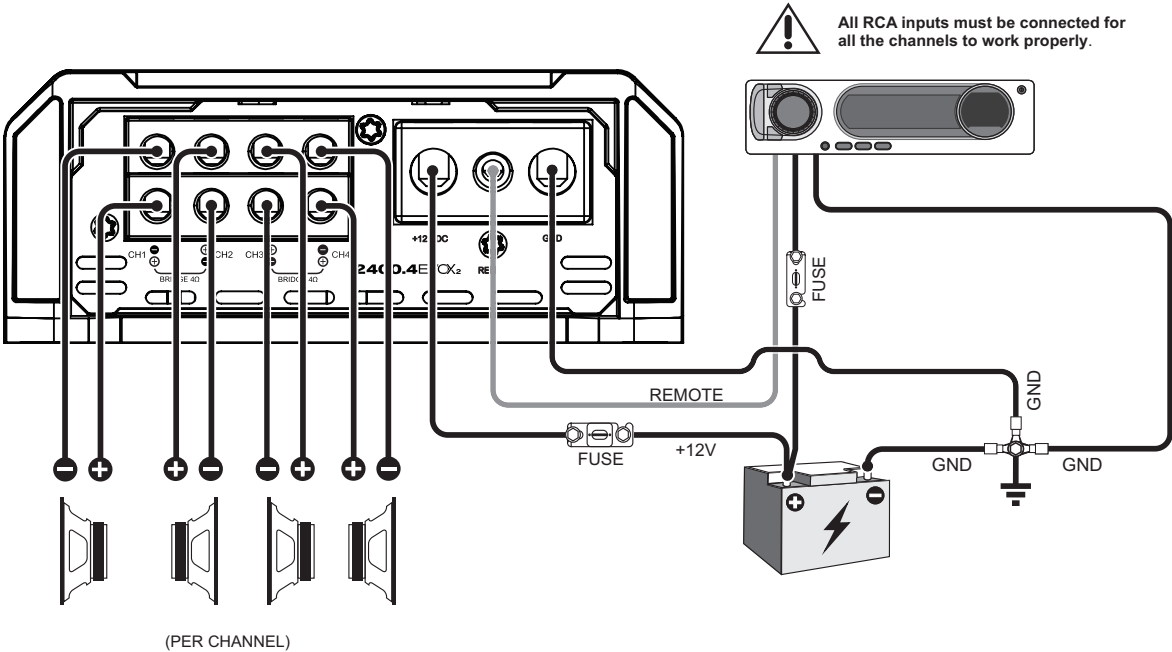

3 CHANNEL WIRING DIAGRAM

See "AUDIO INPUTS" on page 11

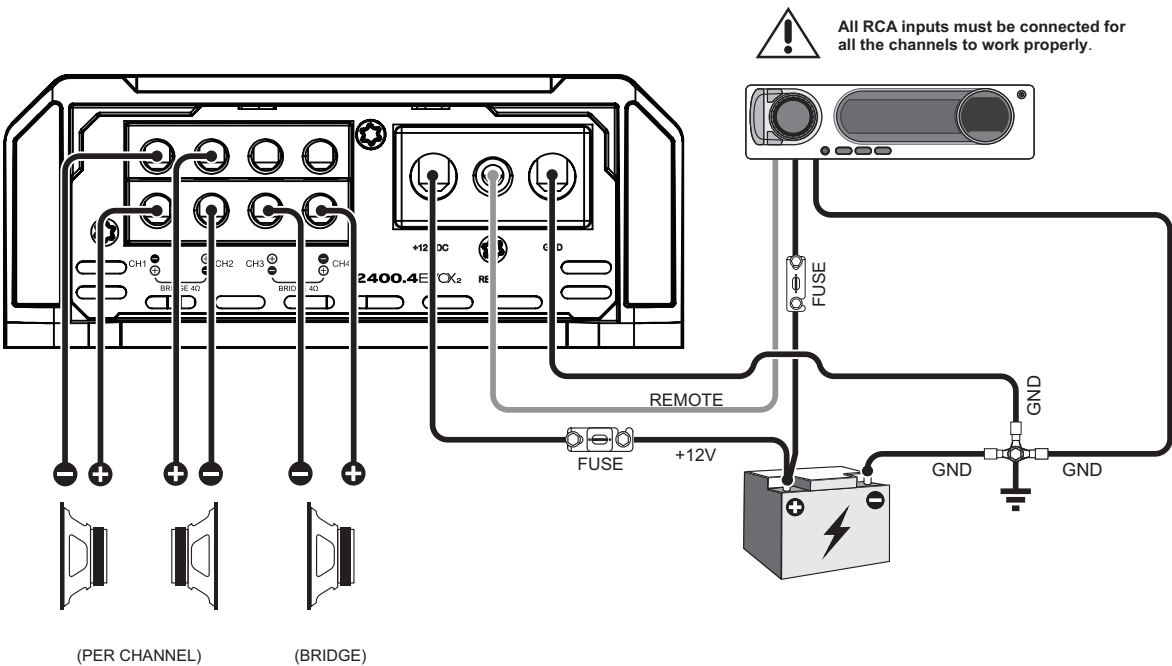

Minimum impedance			
Model		Per channel	Bridge
2400.4 EVOX2	2Ω	1Ω	2Ω
2400.4 EVOX2	4Ω	2Ω	4Ω

## 2 CHANNEL WIRING DIAGRAM

See "AUDIO INPUTS" on page 11

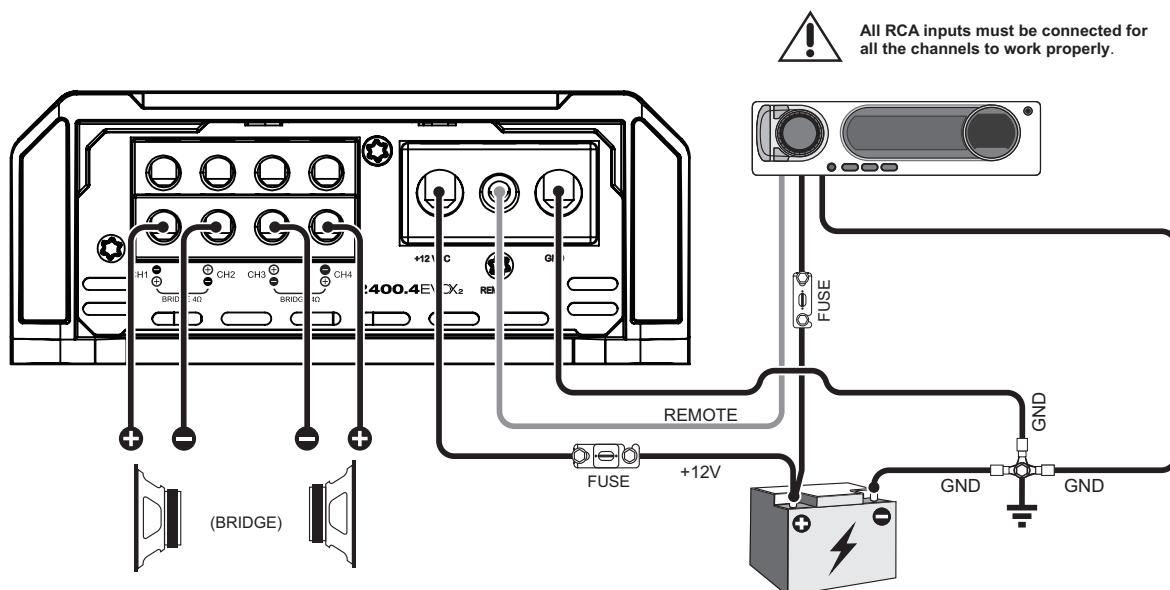

Minimum impedance		
Model	Per channel	Bridge
2400.4 EVOX2 2Ω	1Ω	2Ω
2400.4 EVOX2 4Ω	2Ω	4Ω

## GAIN SETTING

### Necessary equipment:

- Digital AC voltmeter;
- Media with sine wave test tone 60Hz recorded at 0db;
- Screwdriver 1/8" (for gain set).

### Set up procedure

- This procedure is the same for both gain controls;
- Turn the gain control all the way down;
- Disconnect the output cables from the amplifier outputs;
- Turn off all processing (bass, treble, loudness, EQ, etc.);
- Set the source unit volume to 3/4 of full volume;
- Set the audio player fader control to center position (left and right fader controls);
- Set the crossover selector switch in "F";
- Use a 60 Hz sine wave;
- Connect the AC voltmeter to the speaker output connectors of the amplifier. Make sure you test the voltage at the correct connectors (+ and -);
- Increase the gain control until the target voltage is observed with the voltmeter (see the chart below);
- Once you have adjusted the amplifier to the correct voltage output, turn off the source unit and reconnect the speaker(s).

MODEL	STEREO / POWER	BRIDGE / POWER	STEREO OUTPUT VOLTAGE	BRIDGE OUTPUT VOLTAGE
<b>2400.4 EVOX<sub>2</sub> 2Ω</b>	1Ω/ 600W	2Ω/ 1200W	24.5V	49.0V
<b>2400.4 EVOX<sub>2</sub> 4Ω</b>	2Ω/ 600W	4Ω/ 1200W	34.6V	69.3V

Download the tracks for set up in <https://sounddigitalusa.com/tracks-for-set-up/>

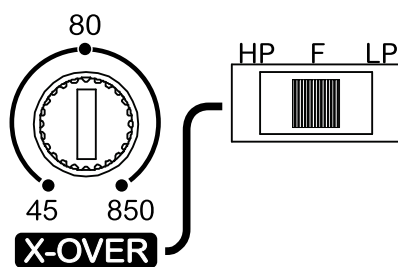

"F" All the frequencies will be reproduced;

"LP" Set in the variable control on Low Pass Function;

"HP" Set in the variable control on High Pass Function.

➤ Change the switch to "F" position (Full Range) - All the frequencies will be reproduced.

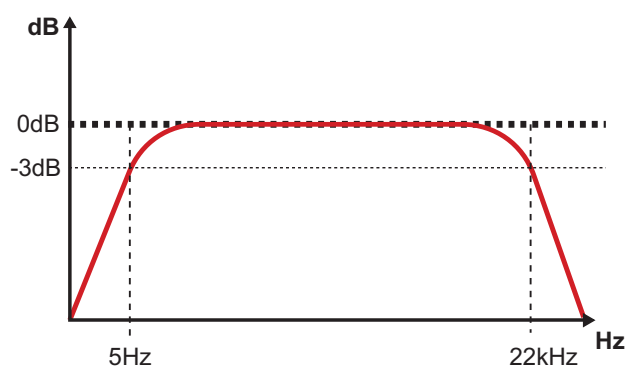

➤ Change the switch to "HP" position - Set in the variable control between 45Hz and 850Hz ("A") where you want to perform the high pass cut filter;

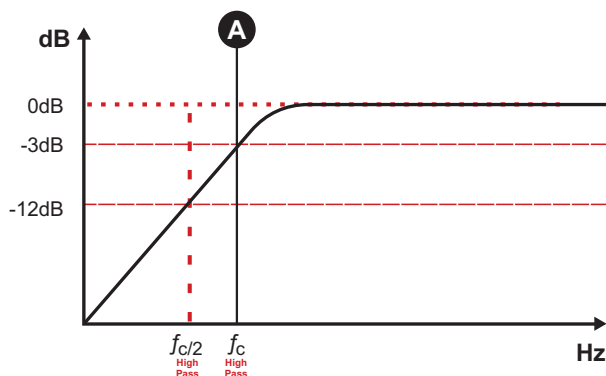

➤ Change the switch to "LP" position - Set in the variable control between 45Hz and 850Hz ("B") where you want to perform the low pass cut filter;

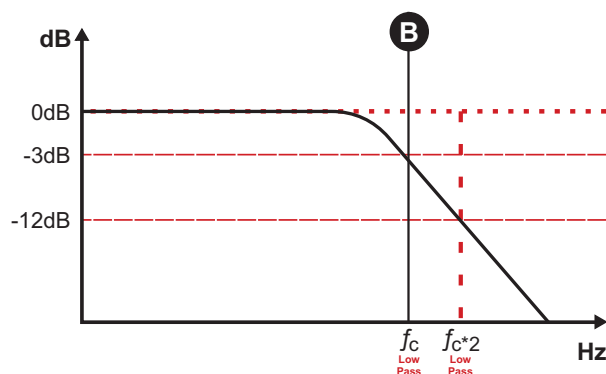

PARAMETERS	2400.4 EVOX <sub>2</sub> 2Ω	2400.4 EVOX <sub>2</sub> 4Ω
RMS Power @ 2Ω**	4 x 396W	4 x 600W
RMS Power @ 1Ω**	4 x 600W	N/A
RMS Power Bridge @ 4Ω**	2 x 792W	2 x 1200W
RMS Power Bridge @ 2Ω**	2 x 1200W	N/A
Frequency response (-3dB)	5Hz ~ 22kHz	5Hz ~ 22kHz
Low pass filter (12dB/octave)	45Hz ~ 850Hz	45Hz ~ 850Hz
High pass filter (12dB/octave)	45Hz ~ 850Hz	45Hz ~ 850Hz
Operating voltage	8V ~ 16V	8V ~ 16V
SNR	88dB	72dB
Input sensitivity (RCA)	0.1 ~ 2V	0.1 ~ 2V
Input sensitivity (High Level input)	1.36 ~ 15.9V	1.36 ~ 15.9V
Current draw (music)	100A	105A
Current draw (max.)	203A	210A
Total efficiency	82%	82%
Damping factor (@100Hz nominal impedance)	200	200
Power cable	21mm <sup>2</sup> (4 AWG)	21mm <sup>2</sup> (4 AWG)
Speaker Cable	2 x 2 mm <sup>2</sup> 14 AWG	2 x 2 mm <sup>2</sup> 14 AWG
Fuse* (music)	120A	120A
Recommended battery (minimum)	120Ah	120Ah

\*It is mandatory to install the fuse at a maximum distance of 12 inches from the battery.

\*\*Power at 14.4V @ 60Hz with a maximum THD of 1%.



**\*\*REAL POWER NUMBERS**  
**CTA-2006 INDUSTRY STANDARDS**

## DIMENSIONAL DATA

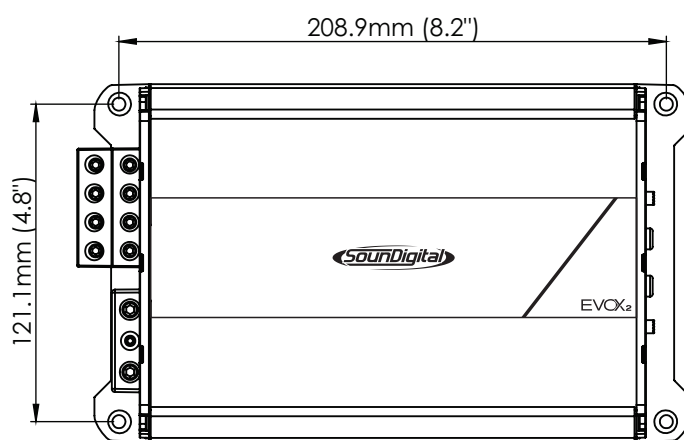
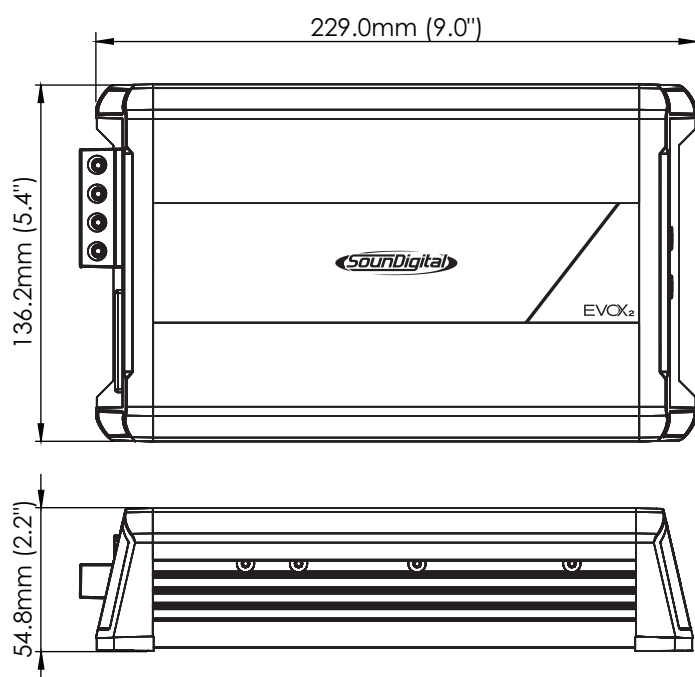

Net Weight	1.67 kg (3.68 lb)
Gross Weight	2.03 kg (4.48 lb)



YOUR MUSIC. **YOUR POWER.**

CODE: 1000750278-003/JAN2023



Consumer  
Technology  
Association™



[WWW.SOUNDDIGITALUSA.COM](http://WWW.SOUNDDIGITALUSA.COM)



[SOUNDDIGITALUSA](#)



[SOUNDDIGITALUSA](#)